

**DESCRIZIONE / DESCRIPTION**

Rubinetto sotto-lavabo ad angolo in ottone stampato, cromato lucido.

*Under washer-basin angle valve made of forged brass, chromium plated*

**FOTO / PICTURE**



**CARATTERISTICHE / FEATURES**

- vitone in ottone con doppia tenuta: doppio o-ring
- guarnizione in NBR
- maniglia in ABS cromato
- rosone in acciaio inox.
- PN 10 – 100°c
- *brass headwork with double tightness: double oring + stuffing box with o-ring.*
- *NBR gasket*
- *ABS handle, chromium plated*
- *stainless steel base ring*
- *PN 10 – 100°c*

**DIMENSIONI PRINCIPALI / LEADING DIMENSIONS**

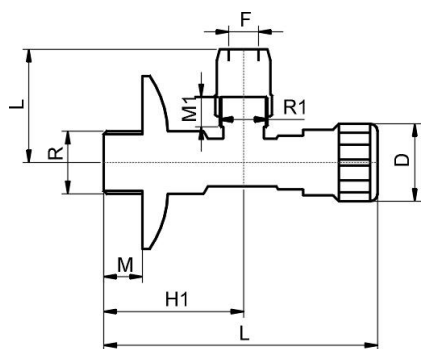

RxR1	1/2"x3/8"
F	10
L	90
H1	47
H	38
M	13
M1	10
D Ø	26

**COMPONENTI / COMPONENTS**

Componenti:  
Components:

- 1 Corpo valvola  
Valve body
- 2 Vitone  
Head work
- 3 Guarnizione  
Gasket
- 4 Maniglia  
Handle

