



343CP

Valvola ad H termostattabile a squadra
Angle H valve thermostatic.



344CP

Valvola ad H termostattabile diritta.
Straight H valve thermostatic.

CARATTERISTICHE - FEATURES

- Corpo calotta e codolo ottone CW617N.
- Componenti interni ottone CW614N
- Volantino in ABS.
- guarnizione tenuta O-ring: EPDM
- finitura superficiale nichelata
- filettature ISO 228/1
- PN 10: TEMP. : -20°C ÷ 100°C
- *brass CW617N body, tail and nut.*
- *Brass CW614N internal components.*
- *ABS cap*
- *Sealing gasket O-ring: EPDM*
- *Nichel plated finishing*
- *threading to ISO 228/1.*
- *PN 10: TEMP. : -20°C ÷ 100°C*

DIMENSIONI PRINCIPALI - LEADING DIMENSIONS

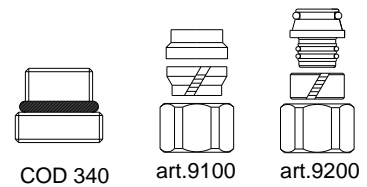
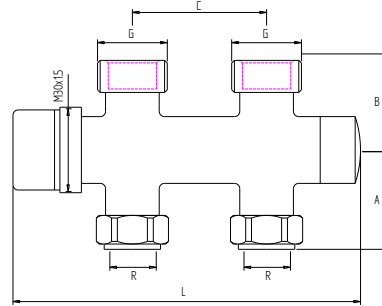
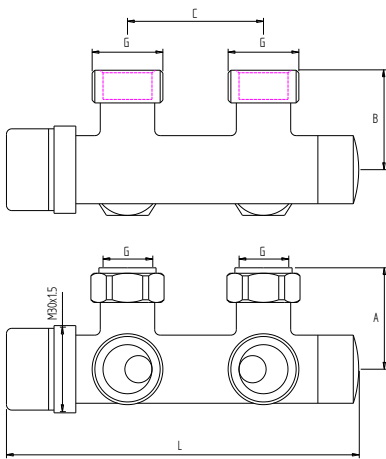

| R | C | A | B | L | G |
|-----|----|----|----|-----|-------|
| 3/4 | 50 | 35 | 28 | 129 | 3/4EK |
| | | | | | |

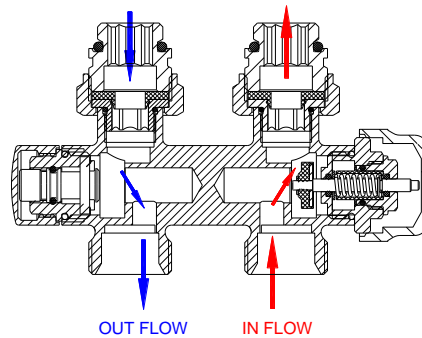

DIAGRAMMA BILANCIAMENTO – BALANCING DIAGRAM

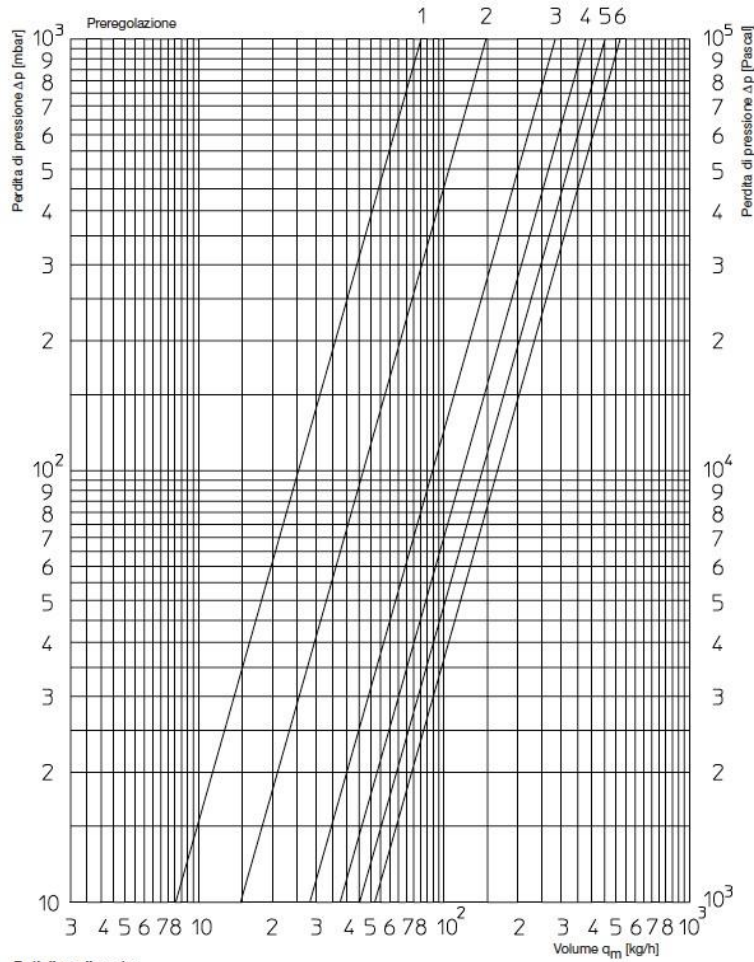

Dati di rendimento:

| Preregolazione | 1 | 2 | 3 | 4 | 5 | 6 |
|----------------------------------|------|------|------|------|------|------|
| Valore kv a 1 K P- scostamento | 0,08 | 0,13 | 0,20 | 0,22 | 0,25 | 0,28 |
| Valore kv a 1,5 K P- scostamento | 0,08 | 0,15 | 0,26 | 0,32 | 0,37 | 0,42 |
| Valore kv a 2 K P- scostamento | 0,08 | 0,15 | 0,28 | 0,37 | 0,44 | 0,52 |
| kvs | | | | | | 0,75 |