

DESCRIZIONE / DESCRIPTION

Valvola a sfera "pesante" a passaggio totale F/F con leva in alluminio T, e in acciaio ST.

Full way heavy duty ball valve F/F with flat steel lever and aluminium T handle

FOTO / PICTURE



1170STN



1170TN



CARATTERISTICHE / DETAILS

- corpo, sfera, asta e premistoppa in ottone CW617N.
- sfera lavorata con utensile in diamante, nichelata e cromata.
- sedi in P.T.F.E. vergine dimensionate con angolo di tenuta di 7° min.
- guarnizione tenuta asta: doppio O-ring in gomma NBR e anello in PTFE.
- leva di comando in alluminio plastificato con resina epossidica rossa (T) leva in acciaio plastificato rosso (ST).
- finitura superficiale sabbiata nichelata, filettature gialle
- filettature ISO 7/1
- PN 40, max. temp. -20° +140°C
- *brass CW617N body end connection and ball.*
- *brass CW614N stuffing box and stem.*
- *ball ground by diamond-tipped tool, chromium plated.*
- *virgin P.T.F.E. seats with 7° min. tightness angle.*
- *stem tightness: double NBR rubber o-ring and PTFE ring.*
- *aluminium lever (T), steel lever with black plastic coating (ST).*
- *nickel plated finishing with yellow threads.*
- *threading to ISO 7/1.*
- *PN 40, max. temp. -20° + 140°C*

DIMENSIONI PRINCIPALI / LEADING DIMENSIONS

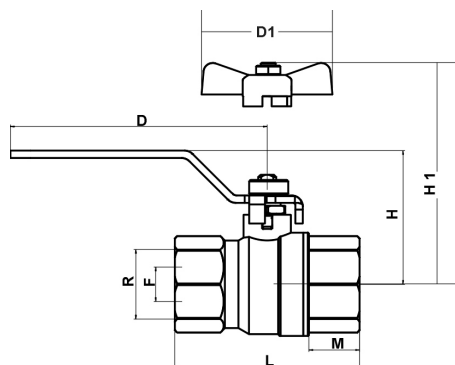

R"	1/2	3/4	1	1 ¼	1 ½	2
D	85	85	114	142	142	150
D1	54	54	70	-	-	-
H1	37.5	40.5	51	-	-	-
H	51	54	62	76	81	89
L	60	70	82	98	105	126
M	17	19	22	25	25	28
F	15	20	25	32	40	50

PRESSIONI DI ESERCIZIO A MAX 80°C / WORKING PREASSURES AT 80°C

PN 40		*	*	*	*	*	*					p.s.i. 600
PN 30												p.s.i. 435
PN 25												p.s.i. 350
PN 20												p.s.i. 300
PN 16												p.s.i. 250
PN 10												p.s.i. 150
	3/8"	1/2"	3/4"	1"	1 ¼"	1 ½"	2"	2 ½"	3"	4"		

PERDITE DI CARICO / PRESSURE DROPS

R"	3/8	1/2	3/4	1	1 ¼	1 ½	2	2 ½	3	4
Kv	-	15	30	57,5	94	160	265	-	-	-

$$\Delta P \text{ [mm H}_2\text{O]} = 10.000 \times \left[\frac{G \text{ [mc/ h]}}{Kv} \right]^2$$

**Diagramma Pressione-Temperatura
Pressure - Temperature diagram**

Nbr

1170; Heavy series

BEST & BIG Series: all dim...
STRONG Series: > 1"

WELL Series: all dim ...

Max press. Per altro
for other products.

