

DESCRIZIONE - DESCRIPTION

Valvola di sfogo aria automatica

Automatic air vent



CARATTERISTICHE - FEATURES

- Corpo in ottone CW617N.
- Galleggiante in POM
- PN 10, T: 110°C
- Portata: 30 L/min a 3 bar
- Brass CW617N body.
- Float POM
- PN 10, T: 110°C
- Flow Rate: 30 L/min to 3bar

DIMENSIONI PRINCIPALI - LEADING DIMENSIONS

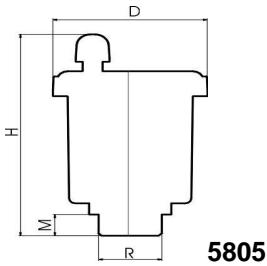

R"	3/8	1/2	
M	8	9	
D	47	47	
H	74	74	

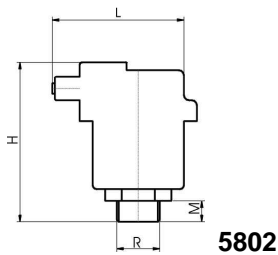

R"	3/8	1/2	
M	8	9	
D	50	50	
H	61	63	

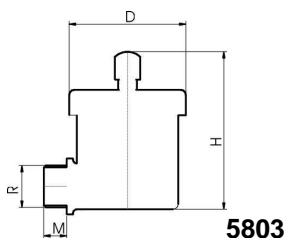

R"	3/8	1/2	
M	8	9	
D	46	46	
H	62	62	